

logitech®

SMARTER THAN THE AVERAGE DOCK.



Logitech SmartDock

Logitech® SmartDock is an AV Control Console that revolutionizes the Skype Room System collaboration experience. Simply walk into a conference room and start your meeting with one-touch join.

Designed in partnership with Microsoft®, SmartDock enables expanded I/O for Surface® Pro that includes support for dual HDMI displays¹, three USB 3.1 ports and Gigabit

Ethernet, allowing the IT administrator to connect recommended devices, such as Logitech ConferenceCams. An embedded motion sensor activates the system when anyone enters the room. Content sharing from a laptop is a snap with 1080p60 HDMI input and capture. With the optional extender box, a single 5 m cable with HDMI, USB, LAN and power provides a clean and streamlined

installation on the conference table. The pivoting, cast-metal base provides enhanced security for Surface Pro. The combination of tamper-resistant screws and a K-lock ensures that the tablet is always in place and ready for your meeting.

With SmartDock, pure elegance meets total control to enable consistently remarkable Skype for Business collaboration.

Logitech SmartDock

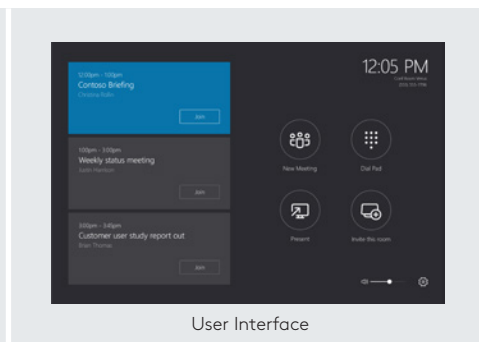
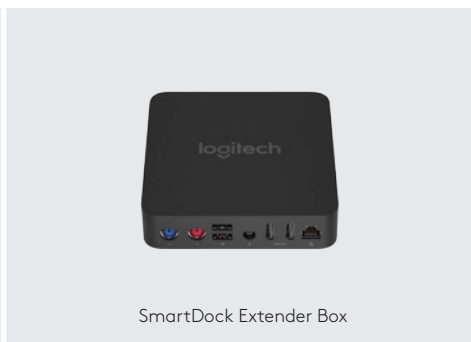

FEATURES & BENEFITS

AV console

SmartDock and Microsoft Surface Pro optimize the Skype Room System collaboration experience in meeting spaces. Leave your laptop at your desk, walk into any meeting space, and start an optimized Skype for Business video conference with one-touch join.

Powered, secure mount for Surface Pro

Tamper-resistant screws and a K-lock provide enhanced security and help ensure that Surface Pro is always in place, charged, and ready for the most important meeting—yours!

Pivoting, cast-metal support platform

The sturdy, elegantly designed base provides a premium mount for Surface Pro with elegant industrial design.

Extended I/O for Surface Pro

Supports a wide variety of deployments and device connectivity with dual 1080p display ports¹, an HDMI input for 1080p60 content sharing, three USB 3.1 type A ports, Gigabit Ethernet, and a headset mini-plug.

IR motion sensor

Conveniently wakes the system when motion is detected in the meeting space and enables energy saving hibernation mode when the room is empty.

Streamlined deployment

An optional extender box combines HDMI, USB, LAN and power cords into a single 5 m cable for a clean, clutter-free installation on the conference table.

Integrated support for Logitech GROUP in optional Extender Box

When used with Logitech GROUP, SmartDock Extender Box eliminates the need for the GROUP hub, power supply and associated cables.

Designed in partnership with Microsoft

Close collaboration between Logitech and Microsoft ensures full and seamless integration with Surface Pro and Skype Room System.

Plug-and-play camera setup

Simply connect camera to powered hub with 5 m /16' cable provided to get up and running in a snap.

SmartDock works with all Logitech ConferenceCams

SmartDock works with a wide range of meeting room AV devices. All Logitech ConferenceCams work with SmartDock.

Optimized for Skype Room System

SmartDock provides a low-cost, high-quality Skype Room System collaboration experience in shared meeting spaces.

PRODUCT SPECIFICATIONS

SmartDock

Part #: 960-001093
UPC: 097855125071

Extender Box

Part #: 960-001095
UPC: 097855125118

SmartDock + Extender Box

Part #: 960-001094
UPC: 097855125088

Pricing excludes Microsoft Surface Pro and Skype for Business meeting room client.

PRODUCT DIMENSIONS + WEIGHT

SmartDock

239 x 334 x 209 mm
9.4 x 13.2 x 8.2"
2738 g/6.04 lb

Extender Box

34 x 128 x 128 mm
1.3 x 5.0 x 5.0"
360 g/0.79 lb

Cable Length

HDMI: 3 m/9.8'
Network: 3 m/9.8'
Power: 3 m/9.8'
Extender Box: 5 m/16.4'

INSIDE THE BOX

SmartDock

Power Supply
Ethernet cable
Two HDMI cables
Assembly tools
Documentation
Logitech SmartDock

SmartDock Extender Box

5 m/16 ft Extender Cable
VESA Mounting Plate 100x100 mm
Hook and loop pads
Documentation
Logitech SmartDock Extender Box

SmartDock + Extender Box

All components included with Logitech SmartDock and Logitech SmartDock Extender Box

SYSTEM REQUIREMENTS

Microsoft Surface Pro 4 with Core i5 or Surface Pro with Core i5 or higher (2017)

Microsoft Windows 10 Enterprise

Skype Room System Software

Room resource account for Skype for Business 2015 or later

Internet access via Ethernet with DHCP enabled

External Display or Projector with HDMI input

Logitech ConferenceCam (recommended) or other Skype Certified A/V Devices

100-240v AC Power

CERTIFICATIONS

SmartDock

Windows 10
FCC
UL

Extender Box

Windows 10
FCC
UL

WARRANTY

2-year limited hardware

www.logitech.com/SmartDock

To order, contact your reseller or call us at 800-308-8666

Published July 2017

Logitech Inc. 7700 Gateway Blvd., Newark, CA 94560

¹ When supported by Microsoft.

² Contact your channel reseller for pricing information.

³ For bundle options with a Logitech ConferenceCam, contact your channel reseller.

© 2017 Logitech. Logitech, the Logitech logo and other Logitech marks are owned by Logitech and may be registered.

All other trademarks are the properties of their respective owners. Logitech assumes no responsibility for any errors that may appear in this publication. Product, pricing and feature information contained herein is subject to change without notice.